



Tray with universal base VCA 060

Cod. 90120060



Qualifying Product **CE**

USER MANUAL

VAIMAS SRL

Via Volpato, 39
36035 Marano Vicentino VI

AZIENDA CON SISTEMA
DI GESTIONE QUALITÀ
CERTIFICATO DA DNV GL
= ISO 9001 =

Direttiva 93/42 CEE
Ausili Medici Classe I

Rev. 1,1

DESCRIPTION COMPONENTS

Remove the item from the packaging and check for all components

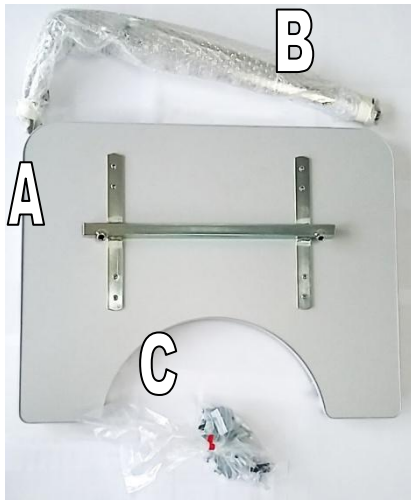

A - Universal tray

B - 2 steps to insert

C - 4 screws 5x35 + 4 screws 5x38 (for wood)

2 attachments with nut + 2 attachments

2 Wing nut

ASSEMBLY INSTRUCTIONS

Begin by loosening grains using a 5 mm wrench;
Thread the two rods on the sides. **DO NOT TILT THE GRANTS** until assembly is complete.

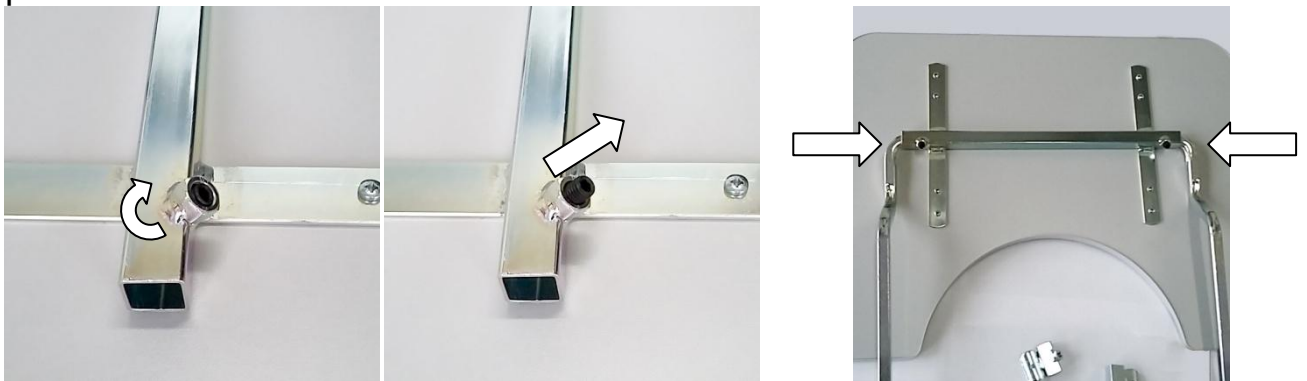

Attach the brackets underneath the comfortable armrest, using type A screws in the case of commoda VAIMAS, type B screws in the case of a wooden armrest.



The attachment for the wing nut must be positioned at the front of commoda.



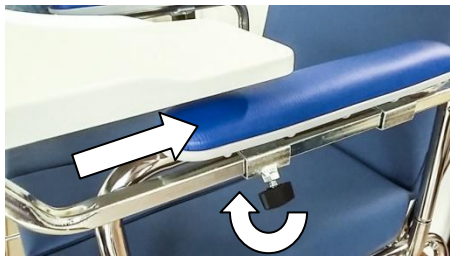

Adjust the width of the two rods to that of the armrests and proceed by inserting the tray by sliding the rods into the joints.



Secure the rods by tightening the wing nut.

Finally, tighten the grains, after assembly is complete.

TECHNICAL DATA

Depth	68 cm
Width	72 cm
Overall size	9 cm

Weight of the universal tray	4,5 Kg
Maximum sustainable weight	20 Kg

CLEANING

It is recommended to use common, non-abrasive and non-corrosive detergents on the surface of the shore by passing a damp cloth on the surfaces and drying immediately.

DEMOLITION AND DISPOSAL

If disassembled, disassemble the various components by grouping them by type of material, then dispose of them in accordance with current regulations.

WARRANTY

The warranty covers the period of TWO years from the date of purchase confirmed by the tax receipt and covers any defects in materials and workmanship that may be present before delivery. Any faults or faults found must be promptly communicated to your distributor or area agent. At its sole discretion, Vaimas Srl may act by repairing the defect or replacement of parts or items.